



ENTEGRA
COACH®

Reatta XL



Serial #: 1JSMEABT0M1MK8055
Model: 37K REATTA XL MHA
VIN#: 4VZAR1D93MC089526
Model Year: 2021 Dealer Name: NATIONAL INDOOR RV CENTERS
4640 NEXUS WAY
NORTH LAS VEGAS, NV 89115
USA

Standard Equipment

THE FOLLOWING ITEMS ARE STANDARD ON THIS MODEL
AT NO EXTRA CHARGE

- Exterior
- Spartan® K2 raised-rail chassis
 - Cummins® L9 turbocharged 380 HP engine 1,150 lb. ft. torque at 1,400 RPM
 - Allison® 3,000 MH 6-speed transmission
 - Rear-mounted radiator
 - Floors- Vacuum-bonded layers of Darco underbelly, a welded aluminum frame, R-9 bead-foam insulation, 3/8" Structurewood® and 1/4" plywood
 - X-Bridge™ bracing welded into chassis frame
 - Steel-reinforced front cap and windshield frame
 - Insulated front and rear caps (R-24)
 - Roof- One-piece fiberglass with 3/8" plywood decking, 4" arched aluminum trusses, insulation and reflective Flexfoil® (R-24)
 - Electric-powered slideout rooms
 - Sidewalls- Vacuum-bonded, high-gloss gelcoat with R-8 bead-foam insulation
 - (2) L16 AGM batteries (6V/390 amp hrs. ea.)
 - Black holding tank sprayer
 - Sani-Con® Macerator holding tank dump system with manual gate valves and manual backup
 - 50 amp power cord on electric powered reel
 - Aqua-Hot® 250D hydronic water and heating system with electric radiant floor heating system
 - Surge protector transfer switch
 - City and tank water filtration system
 - Winterizing drain system
 - Daytime running lights
 - Power entrance door awning with LED lights
 - Slideout awnings
 - Diamond Shield™ front protective film mask
 - Halogen high/low beam headlights and fog lights
 - Grab handle with keypad system for keyless entry
 - LED marker lights, third brake light, turn lights, license plate light, accent lights, & docking lights
 - Heated, remote control, side-view mirrors with integrated cameras
 - Full-width rear mudflap, with chrome "Entegra" nameplate
 - Winegard® TRAV'LER satellite dish DIRECTV®-standard with USA option
 - Exterior utility center
 - Winegard® Rayzar Z1 TV antenna
 - Winegard® WIFI extender with 4G/LTE
 - Slideout basement storage tray
 - Frameless, tinted, dual-pane, safety-glass windows
 - Michelin® 275/80R 22.5" tires
 - Bilstein® 46mm shocks
 - Spartan® Safehaul tow vehicle air brake system
 - 10,000 lb. hitch with 7/4-pin plug
 - Window awnings
 - Ultra-Vision® one-piece wrap-around tinted windshield
 - Sikkens custom full body paint

- Interior
- Valid 12.3" digital dash with quad core graphics processor with ability to display on-board diagnostics, traditional instrument cluster, 360 degree camera system or Rand McNally™ GPS navigation.
 - Xite™ 360° camera system that displays on digital dash screen
 - (2) dual USB ports and (2) 12V socket for charging
 - Power adjustable driver and passenger seats with integrated seatbelt and power foot rests
 - Power adjustable brake and accelerator pedals
 - Tire pressure monitoring system (TPMS) with temperature monitoring
 - Tilt and telescoping steering wheel with integrated controls for cruise ,wipers, radio controls and Bluetooth phone functionality
 - Xite™ XSG3 infotainment system with navigation, Bluetooth, Sirius XM and AM/FM tuner
 - Powered front sun visors and privacy shade
 - 10" VegaTouch touchpad system for complete integration of coach controls (mobile app available)
 - LG® Blu-Ray™ player
 - Hand-laid polished porcelain floor tiles
 - Flexsteel® furniture
 - Recessed, 12V, LED lighting
 - 50" Insignia™ LED TV
 - Insignia™ sound bar
 - Induction cooktop
 - Solid surface countertops with single bowel stainless steel sink in kitchen
 - 1.5 cu. ft. convection microwave oven
 - Whirlpool® stainless steel residential refrigerator with ice maker and water dispenser
 - Fan-Tastic power exhaust fan with intake
 - King-sized pillow top mattress on tilt bed
 - LG® Blu-Ray™ player
 - 32" Insignia™ LED TV
 - One-piece fiberglass shower with skylight
 - Solid surface countertops with integrated sink
 - Thetford® Aqua Magic toilet with foot flush
 - Carbon monoxide detector
 - Fireplace (37K only)
 - Whirlpool® stacked washer and dryer
 - Solar power prep
 - Central vacuum system
 - Front overhead Insignia 32" LED TV
 - Window with slider and screen
 - Removable screen on entry door
 - Aqua View Showermiser water saving system

- Customer Value Package
- Onan® 10,000 watt diesel generator, with automatic start, on slide-out tray
 - 2,000 watt pure sine wave inverter with 100 amp battery charger
 - (3) 15,000 BTU A/C units with heat pumps [(2)15,000 BTU units with heat pumps on 37K]
 - Equalizer hydraulic automatic coach leveling
 - Backup and sideview cameras
 - Power patio awning with LED lights
 - Exterior 39" LED TV on adjustable TV bracket
 - Manual solar shade with blackout night shades

Optional Equipment

OPTIONAL EQUIPMENT INSTALLED ON THIS VEHICLE
BY MANUFACTURER

- Base price 357,743.00
Onyx n/c
Stonewall Gray Cabinetry 4,493.00
Ironstone Paint n/c
USA Standards n/c
21 SP 36320 230" 380 ISL
2017 EMISSION MXD n/c
Customer Value Package 11,250.00
Trav'ler Direct TV
Satellite Dish n/c
Theater Seating Sofa 1,200.00

UNIT TOTAL 374,686.00

DEALER INSTALLED OPTIONS

Manufacturer's Suggested Retail Price \$374,686.00

TOTAL AMOUNT DOES NOT INCLUDE STATE AND LOCAL TAXES OR LICENSE FEES. THE PRICE SHOWN ABOVE MAY OR MAY NOT BE REPRESENTATIVE OF THE ACTUAL SELLING PRICE OF SIMILAR RECREATIONAL VEHICLES IN YOUR AREA.

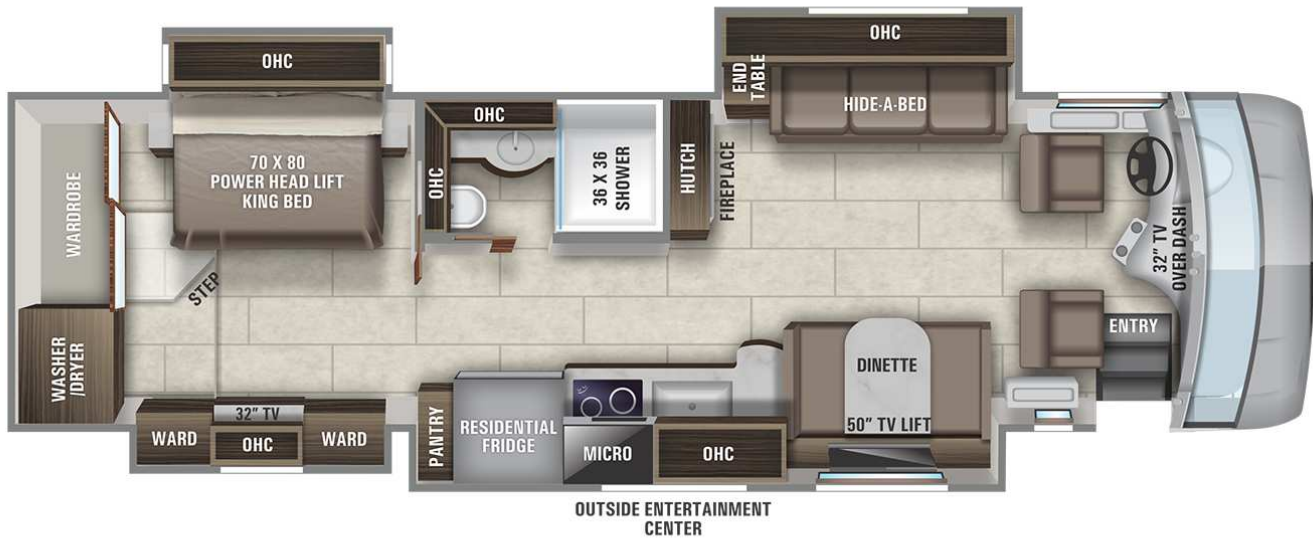

DIMENSIONS

Exterior height:.....154.00"
Exterior width:.....101.00"

CAPACITIES

Fresh water tank (gals.):..100.00
Gray water tank (gals.):....62.00
Black water/toilet tank (gals.):.....41.00
Propane (lbs.):.....0
Propane (gals.):.....0
Water heater (gals.):.....0.00

TIRES

Tire size (front):.....275/80R22.5
Tire size (mid):.....
Tire size (rear):.....275/80R22.5

Some dimensions may be rounded and may vary from the acutal dimensions

***Weights may be estimated calculations and may vary from the actual weight

- refer to the vehicle weight labels for actual weights***

Floorplans, features and specifications are subject to change without notice.